

stûv *P-10*

A new vision on fire

P-10

Stûv Stories +Stûv P-10

Combining flame picture and pellet efficiency

stuv.com

Stûv Stories

Welcome to the world of Stûv! Our products provide ways to layout and rearrange your interior. The story that they tell is straightforward and warm, simple and efficient. A story where appearance is functional and where objects blend into the architecture. Quality and perfection are the watchwords at Stûv. To improve is to simplify. This means humanising design. It also means constant innovation until a perfect harmony is found between pleasure and respect for the environment. Stûv. The essential fire.

Stûv Stories +Stûv P-10

Face-to-face with fire

Model shown: Stûv P-10 with wooden base, dark oak





lines

merged into
architecture





Stûv Stories +Stûv P-10

A radiant presence and shining performance



With its elegant design and advanced heat technology, the Stûv P-10 is integrated into the heart of your living space. Stûv P-10 means making the most of an efficient, pleasant and controlled heat. Relax in front of the dancing flames, thanks to the patented technology which brings calm and fullness to the flame from wood pellets. Make the most of the diffusion of this natural heat, silent and controlled. The Stûv P-10 is a wood pellet stove that is one of a kind, combining looks, function and authenticity.

Spotlight on heat

- + Pellet stove giving a broad, full flame
- + Pivoting upper part
- + Operates silently
- + Bottom part faced in steel , wood or can be customised
- + Remote control with thermostat



Model shown: Stuv P-10 with steel base

1



Stûv Stories +Stûv P-10

The top part of the stove pivots to direct radiant heat and offer the best view of the fire through the large window.

Patented technology for a sculpted flame



- + Patented technology to shape the flame
- + Natural convection adjustable between 2,5 and 8 kW
- + Radiation through the large window
- + Wood pellets are lifted, no annoying clattering

Model shown: Stûv P-10 with wooden base, bleached oak

Stûv Stories +Stûv P-10

Enjoy the silence

thanks to natural convection and radiation



Stûv Stories +Stûv P-10

A loyal companion who obeys your every command

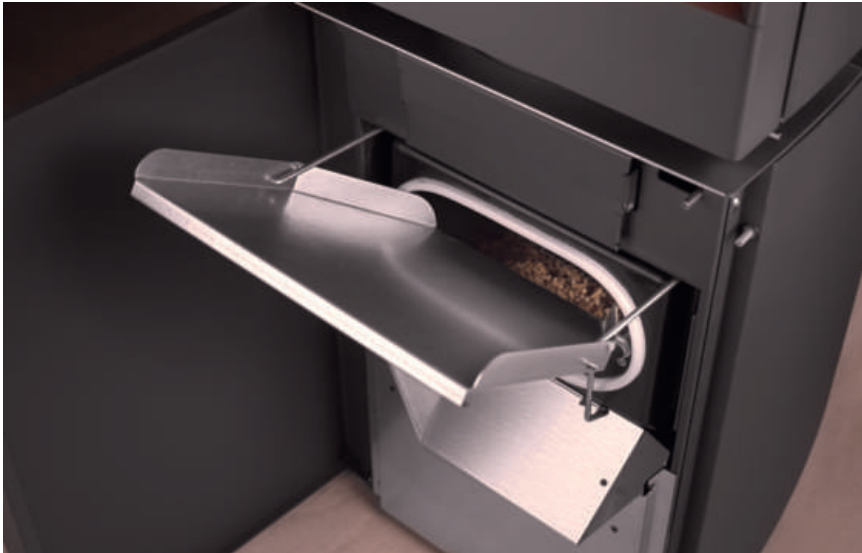

The loading hatch enables pellets to be loaded at hip height. The hopper can hold 18kg, corresponding to 10 hours of heating at maximum power, 30 hours of heating at minimum power. The ash pan allows for easy removal of ash. The design of the appliance makes glass cleaning and maintenance simple.



- + Remote control with thermostat and integrated regulation
- + Automatically adapts to the size of pellet
- + Automatic adjustment of the air flow



Model shown: Stuv P-10 with trimmable base, customised in wood

Stûv P-10

technical information



Specifications	P-10
weight kg	175
nominal heat power kW	8
optimum output range kW	2,5 – 8
efficiency %	> 90
CO emissions %	<0,02
particle emissions mg/Nm ³	<20
hopper capacity kg	18
heating time (min/max) h	10 – 30
pellet consumption rate kg/h	0,6 – 1,8
outside air intake Ø – mm	60
electrical consumption W	40
Features	P-10
+ pivoting top part (manual)	standard
+ ash removal system (manual)	standard
+ removable ash pan	standard
+ remote control with thermostat and integrated regulation	standard
+ system for automatic adaptation to pellet length	standard
Patents	P-10

EU 2304319JP 5390603US 8,904,944

US 8,826,899

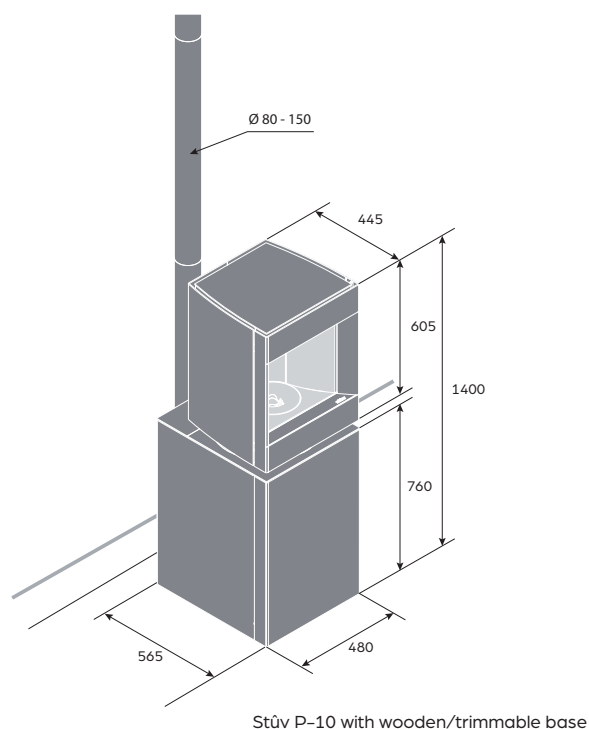
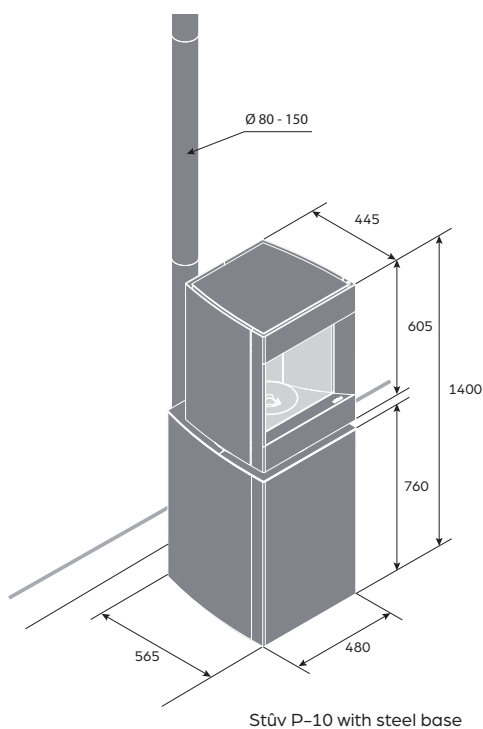

Combustion and convection

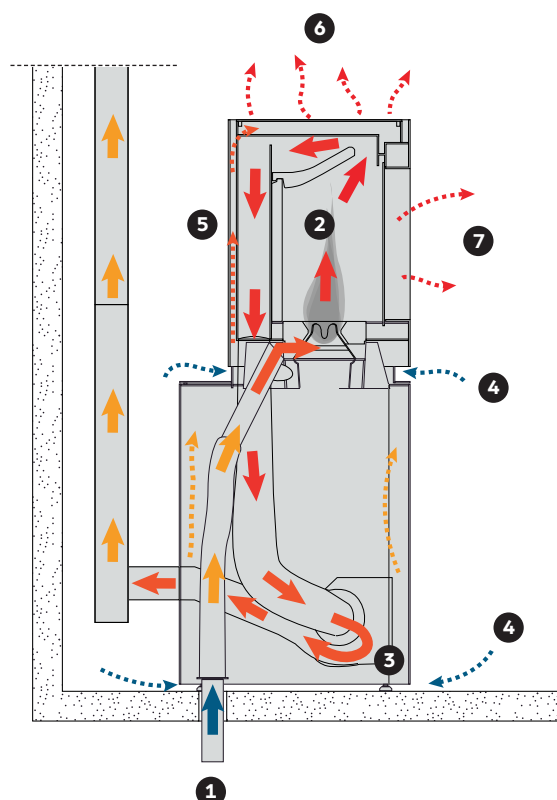

Pellet conveying

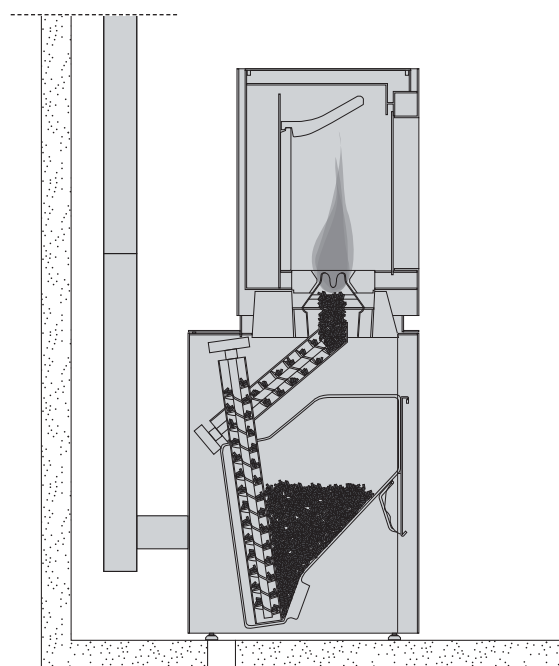

- 1** The air needed for combustion is drawn from the outside of the building envelope (under the stove or at the back of the appliance).
- 2** The air intake, the combustion chamber and form an airtight system which does not hinder the insulation and ventilation of the building.
- 3** The smoke passes through a heat exchanger, is sucked through a fan and then vented through the flue.
- 4** The air of the living room is drawn to be reheated.
- 5** Air circulates in the convection chamber and harnesses the heat from the fumes.
- 6** The heated air emerges naturally from the appliance and spreads through the room.
- 7** Heat radiates through the large glass window.

The constant search for improvement...

Stûv intensively invests in research and development in both its own laboratory and thanks to its partnerships with specialists in the field of combustion. Each detail is important in optimising the performance of the stove. Stûv devices meet the most stringent standards in terms of respect for the environment. We give priority to ergonomics and simplicity at all stages – installation, use, maintenance – so that every user can use their Stûv exactly how they want it. This is the reason we provide detailed installation instructions, we select our sales network and organise training sessions for our retail and installations partners.

The Stûv guarantee

- + Stûv fires are renowned for their design and performance. They are also solid, reliable and durable.
- + The fires and their components are made in Europe with the utmost care. A well-maintained Stûv fire is for life.
- + This is why Stûv offers the users of its products an extended guarantee. Three years' guarantee in addition to the legal guarantee.
- + In total, 5 years on the body of the fire, 3 years on the electrical components and 3 years on the other components. For detailed information, visit stuv.com.

What do you need to do to benefit from this extended warranty?

Complete the guarantee form that you will find at the end of the user manual and return the hard copy to Stûv or – the easier option – fill out the online form at stuv.com.



Stûv P-10 original concept by Gabaan

Stûv pellet stoves are designed to burn wood pellets of DIN+ or ENplus-A1 quality.

The Stûv P-10 has been tested according to the EN 14785 (CE) standard.

Complies with the following standards and quality labels:

Flamme verte 7* (FR), Paris PPA (FR), BlmSchV2 (DE), 15A (AT), EcoDesign (EU)

Colophon

design Brigitte Boits

photography François Chevalier

styling Edith Vervest

communication manager Serge Alhadeff

responsible editor Gérard Pitance

Documents and photos are for information purposes only. Stûv reserves the right to make changes without warning. Every care has been taken in the preparation of this brochure; however, we do not accept any responsibility for any mistakes that it may contain.



Stûv Stories

+Find out about all
the products in the
Stûv range

+ wood

Stûv 16 | Stûv 21 | Stûv 22 |

Stûv 30 | Stûv 30-compact |

Stûv microMega

+ gas

Stûv tulp

+ pellets

Stûv P-10

Stûv stoves are distributed by :

Stûv stoves are designed and
manufactured by: **Stûv nv**
rue Jules Borbouse 4
B - 5170 Bois-de-Villers
Belgium
info@stuv.com
stuv.com

join us



stûv

The essential fire